

 **PHOENIX GOLD**

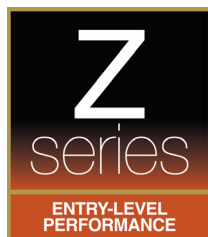

Z8AB / Z10AB / Z12AB

ACTIVE SUBWOOFER ENCLOSURES



SPECIFICATIONS

MODEL NO	Z8AB	Z10AB	Z12AB
MAX Power (Watts)	500 Watts	800 Watts	1000 Watts
RMS Power (Watts)	125 Watts	200 Watts	500 Watts
Amplifier Type	Class-AB	Class-AB	Class-AB
Frequency Response	25-200hz	25-200hz	10Hz - 200Hz
Signal to Noise Ratio	>60dB	>60dB	>60dB
Crossover Slope	6dB per octave	6dB per octave	6dB per octave
Crossover Range	50Hz - 200Hz	50Hz - 200Hz	50Hz - 200Hz
Tuning	Bass Reflex	Bass Reflex	Bass Reflex
Woofer Size	8" / 200mm	10" / 250mm	12" / 300mm
Fuse	15A	15A	15A
Auto Turn-On	Yes	Yes	Yes
Dimensions (mm)	400 x 295 x 280mm	476 x 343 x 331mm	560 x 384 x 394mm

INSTALLATION

Make sure the active enclosure is firmly fixed in your vehicle. Check before drilling or cutting holes. DO NOT work near fuel tanks, fuel lines hydraulic lines or electrical wiring.

DO NOT mount the active enclosure in such a way as to pinch or damage the wires.

Make sure everything is firmly connected before attaching a +12V wire.

Ensure the +12V wire is fused as close as possible to the battery. Always use a fuse with the recommended rating.

CONTROL DESCRIPTIONS

LEVEL

This allows the adjustment of the amplifier level of the subwoofer.

Turn clockwise to increase the level. If the sound becomes distorted reduce the level.

LOW PASS FILTER

This allows the adjustment of the highest frequency the active enclosure will produce.

This should be adjusted to blend with your main speakers. Typically, this will be set to around 100Hz (approximately the central position of the control knob).

BASS REMOTE CONTROL

This control can be mounted in the front of the vehicle to give you control of your subwoofers output level.

DISCLAIMER

Always ensure the Active Enclosure is securely attached, to avoid movement.

PHOENIX GOLD accepts no responsibility for damage or injury in relation to inappropriate securing of this product.

WIRING

- ▶ Connect the ground wire to the vehicle first (clean dirt and paint to bare metal)
- ▶ Connect the remote on (blue wire)
- ▶ Connect the RCA cables if applicable OR
- ▶ Connect the speaker level wire into the headunits speaker wires (**See note 1**)
- ▶ Connect the remote level controller with the supplied lead
- ▶ Please ensure power wire is fused within 12" of battery
- ▶ Connect the 12 volt (red wire) to the positive battery terminal.
- ▶ Check all connections.

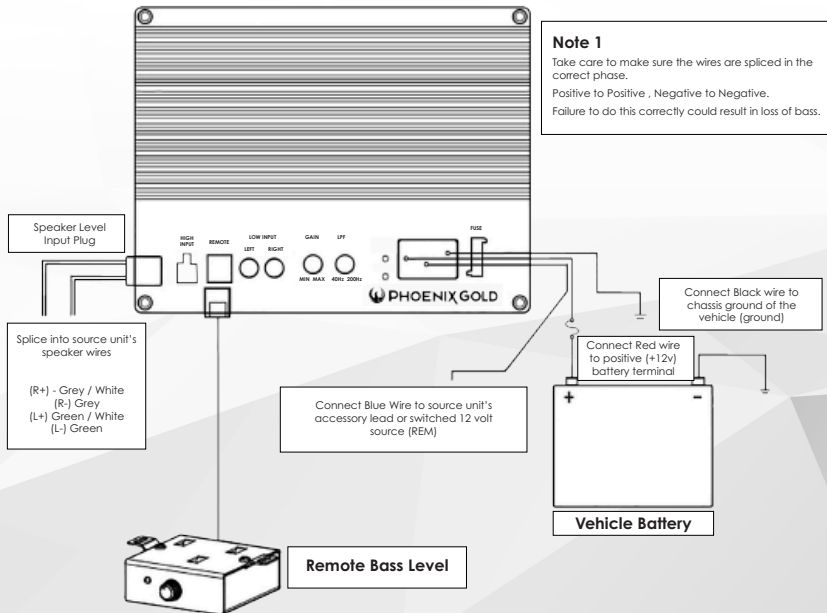



Disclaimer

Always ensure the bass enclosure is securely attached, to avoid movement. PHOENIX GOLD accepts no responsibility for damage or injury in relation to inappropriate securing of this product.

Phoenix Gold Product Warranty

LIMITED WARRANTY ON BASS ENCLOSURES

Phoenix Gold warrants this product to be free of defects in materials and workmanship for a period of one (1) years from the original date of purchase. This warranty is not transferable and applies only to the original purchaser from an authorized Phoenix Gold dealer. Should service be necessary under this warranty for any reason due to manufacturing defect or malfunction, Phoenix Gold or it's Country distributor / reseller will (at its discretion) repair or replace the defective product with new or re-manufactured product at no charge. Damage caused by the following is not covered under warranty: accident, misuse, abuse, product modification or neglect, failure to follow installation instructions, unauthorized repair attempts, misrepresentations by the seller. This warranty does not cover incidental or consequential damages and does not cover the cost of removing or reinstalling the unit(s). Cosmetic damage due to accident or normal wear and tear is not covered under warranty.