

TS-R1350S/XIEL5 THF5544-B/V1

© PIONEER CORPORATION 2013 1-1, Shin-Ohgura, Sawabai, Kawasaki-shi, Kanagawa 212-0031, JAPAN / JAPON MADE IN VIETNAM FABRIQUE AU VIETNAM PIONEER EUROPE NV Haven 1087, Kesterweg 1, B-9120 Mellebe, Belgium / Belgique

● 特徴
 - 最大出力: 250W
 - 音圧レベル: 89dB
 - 口径: 13cm
 - 3音域

● 仕様
 - 最大出力: 250W
 - 音圧レベル: 89dB
 - 口径: 13cm
 - 3音域

● 注意
 - 本製品は、自動車用スピーカーとして設計されています。他の用途には適しません。

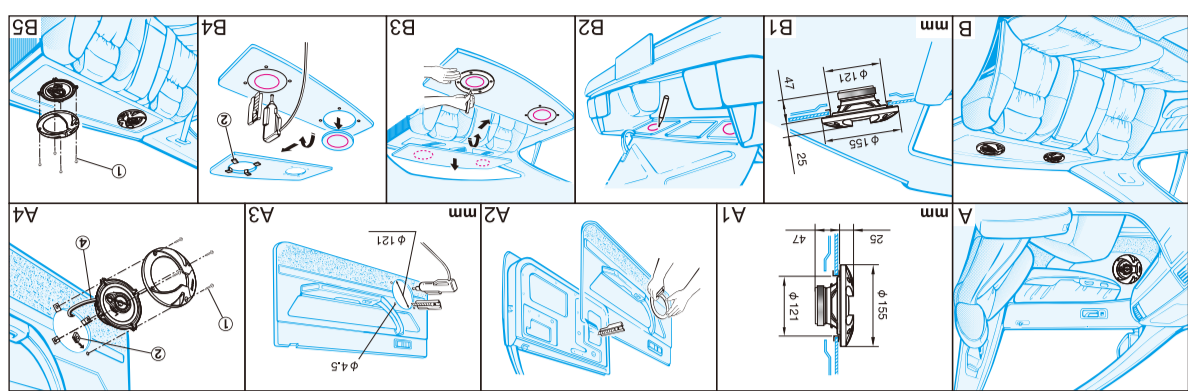

● HOW TO INSTALL
 ● MODE D'INSTALLATION
 ● MODI DI INSTALLAZIONE

● CARATTERISTICHE
 - Potenza massima: 250W
 - Sensibilità: 89dB
 - Altezza: 13cm
 - 3 vie

● FEATURES
 - MAX. MUSIC POWER 250 W
 - SENSITIVITY 89 dB (±1.5 dB)
 - TWEETER Ø13 mm PIEZOELECTRIC
 - MIDRANGE Ø42 mm CONE
 - WOOFER Ø130 mm

TS-R1350S 250W MAX 13 cm COAXIAL 3-WAY Flush-Mount Car Speaker Haut-Parleurs À Montage Encastré Pour Automobile

TS-R1350S
 3-Way Speaker
 250W MAX
 3 WAY VOICES
 13cm

Specifications:
 - MAX. MUSIC POWER 250 W
 - FREQUENCY RESPONSE 44 Hz TO 31 kHz (-20 dB)
 - SENSITIVITY 89 dB (±1.5 dB)
 - IMPEDANCE 4 OHMS
 - TWEETER Ø13 mm PIEZOELECTRIC
 - MIDRANGE Ø42 mm CONE
 - WOOFER Ø130 mm
 - GROSS WEIGHT 1,48 kg

Caution
 - Do not touch the speaker terminals when the speaker is connected to the power source.
 - Do not use the speaker in a wet or damp environment.
 - Do not use the speaker in a high-temperature environment.

Pioneer
TS-R1350S
 3-Way Speaker / HP 3 Voies / Diffuseur 3 Vie
 Altavoz 3 Vías / Alto-falante 3 Vías
 Громкоговоритель 3-Х Полосный

250W MAX
3 WAY VOICES
13cm

Pioneer
TS-R1350S
 3-Way Speaker
 Громкоговоритель 3-Х Полосный

250W MAX
3 WAY VOICES
13cm

TS-R1350S
 HP 3 Voies

- PUISSANCE MUSICALE MAXIMUM 250 W
- PUISSANCE NOMINALE 35 W
- HP GRAVE Ø130 mm
- HP MÉDIUM Ø42 mm CÔNE
- HP AIGU Ø15 mm PIEZOELECTRIC
- IMPÉDANCE 4 OHMS
- SENSIBILITÉ 89 dB (±1,5 dB)
- BANDE PASSANTE 44 Hz À 31 kHz (-20 dB)
- POIDS BRUT 1,48 kg

250W MAX
3 WAY VOICES
13cm

XIEL5
 1 PAIRE

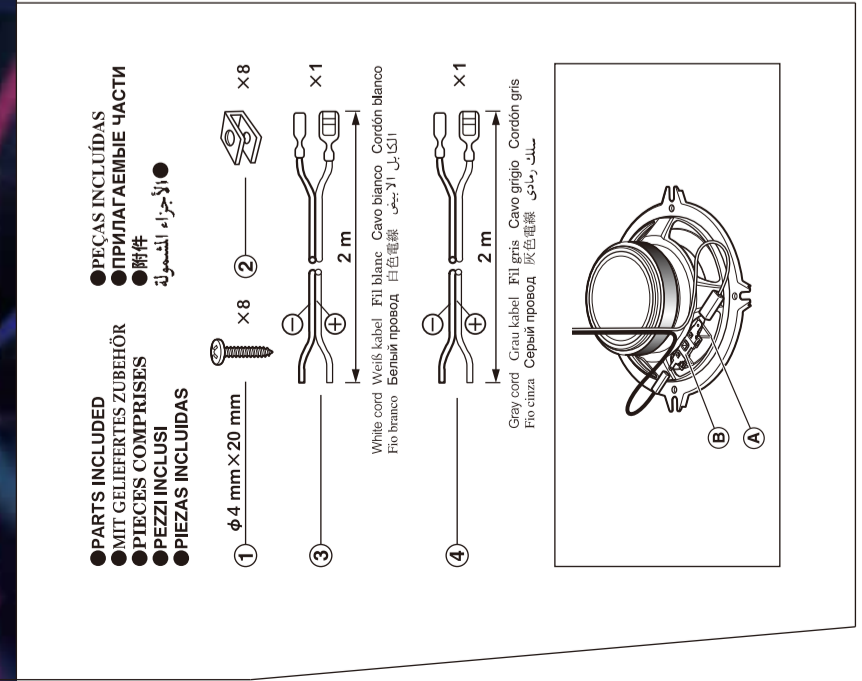

TS-R1350S
 HP 3 Voies

250W MAX
3 WAY VOICES
13cm

TS-R1350S
 HP 3 Voies

250W MAX
3 WAY VOICES
13cm