

IR-X Infrared Remote Repeater Installation Instructions 8-15-03

Control remote mounted / hidden video players and stereos using the units IR remote*.

Special Features:

- Easy 2 wire hook up
- Extra long plug-in wire for remote IR LED
- Red LED flashes for confirmation of wireless remote operation (red LED will be dim when flashing)
- Small and easy to mount
- 40kHz and 56kHz operation

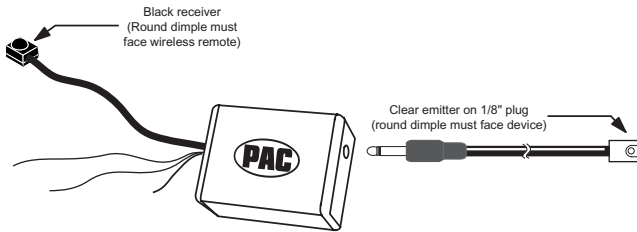

* note: The IR remote being used must use a 40kHz or 56kHz carrier frequency. Consult with equipment manufacture to determine the carrier frequency. Check website for known units that do not work.

Installation Instructions

1. Connect Red wire to 12 volts accessory (switched power)
2. Connect Black wire is vehicle ground (negative)
3. Mount IR receiver (on the end of the short black wire) with the round dome side facing out where it is in range / sight of the remote control.
4. Mount IR LED (on the end of black wire with 1/8" plug) in front of the unit/s to be controlled. The IR LED is directional, so make sure the dimple on the side of the clear IR LED is facing the unit being controlled. It can be taped to the front of the unit or mounted in a location that can be seen by two or more units to be controlled.
5. By leaving the brown wire of the IR-X disconnected and insulated, it will transmit at a 40kHz IR signal, which is used for **most applications**.

-or-

When the brown wire is connected to vehicle ground (negative) the IR-X will transmit at a 56kHz IR signal which is used in fewer applications. Ground the brown wire **only** if the control response is slower than normal or is intermittent.

Pacific Accessory Corporation - 1502 S. Santa Fe Street, Santa Ana, CA 92705
techsupport@pac-audio.com • Voice: 714-835-3022 • Fax: 714-835-3233 • www.pac-audio.com

IR-X Infrared Remote Repeater Installation Instructions 8-15-03

Control remote mounted / hidden video players and stereos using the units IR remote*.

Special Features:

- Easy 2 wire hook up
- Extra long plug-in wire for remote IR LED
- Red LED flashes for confirmation of wireless remote operation (red LED will be dim when flashing)
- Small and easy to mount
- 40kHz and 56kHz operation

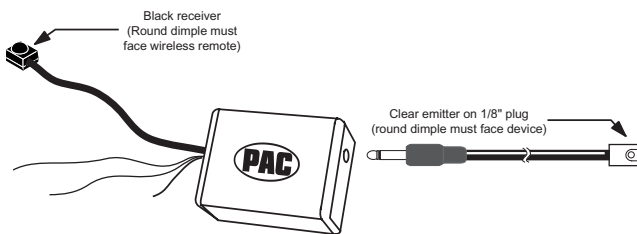

* note: The IR remote being used must use a 40kHz or 56kHz carrier frequency. Consult with equipment manufacture to determine the carrier frequency. Check website for known units that do not work.

Installation Instructions

1. Connect Red wire to 12 volts accessory (switched power)
2. Connect Black wire is vehicle ground (negative)
3. Mount IR receiver (on the end of the short black wire) with the round dome side facing out where it is in range / sight of the remote control.
4. Mount IR LED (on the end of black wire with 1/8" plug) in front of the unit/s to be controlled. The IR LED is directional, so make sure the dimple on the side of the clear IR LED is facing the unit being controlled. It can be taped to the front of the unit or mounted in a location that can be seen by two or more units to be controlled.
5. By leaving the brown wire of the IR-X disconnected and insulated, it will transmit at a 40kHz IR signal, which is used for **most applications**.

-or-

When the brown wire is connected to vehicle ground (negative) the IR-X will transmit at a 56kHz IR signal which is used in fewer applications. Ground the brown wire **only** if the control response is slower than normal or is intermittent.

Pacific Accessory Corporation - 1502 S. Santa Fe Street, Santa Ana, CA 92705
techsupport@pac-audio.com • Voice: 714-835-3022 • Fax: 714-835-3233 • www.pac-audio.com