

APPLICATIONS

BMW 1-Series 2008-10

3-Series 2006-10

(Non Factory NAV, Doesn't Retain Heated Seat Switches)

KIT FEATURES

- Double DIN Head Unit Provision
- ISO Stacked Head Unit Provision
- **Painted matte black**



KIT COMPONENTS

- A) Double DIN Trim Plate
- B) Double DIN Brackets
- C) Two 1/2" #8 Pan Head Screws
- D) Two Plastic Snaps

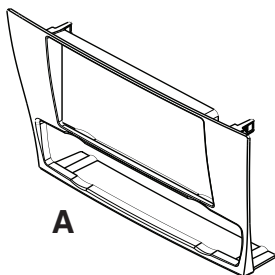

B



C



D

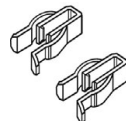

TOOLS REQUIRED:

Small Flat Blade Screwdriver/ Panel Removal Tool
Phillips Screwdriver • Torx Screwdriver • Cutting tool or file

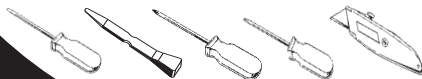

TABLE OF CONTENTS

Dash Disassembly

- BMW 1-Series 2008-10, 3-Series 2006-10

(Non factory NAV)1

Kit Assembly

- Kit Preparation

Double DIN Head Unit Provision/ Stacked ISO DIN Head Unit Provision . . 3

Note:

Refer also to the instructions included with the aftermarket radio.

BMW 1-Series 2008-10/3-Series 2006-10 **(NON FACTORY NAV)**

- 1** Disconnect the negative battery terminal to prevent an accidental short circuit.
- 2** Carefully unclip and remove the climate controls. (Figure A)
- 3** Remove two Phillips screws from the bottom of the radio and remove. (Figure B)
- 4** Remove the four Torx screws from the sub-dash bracket and remove. (Figure C)

Continued on page 2.

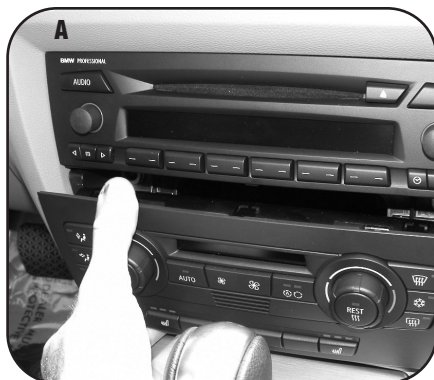

BMW 1-Series 2008-10/3-Series 2006-10
(NON FACTORY NAV)



5 Remove the climate control from the climate control bezel. (Figure D)

6 Cut or file the edges of the climate controls as shown. (Figure E, F)



Continue to kit assembly

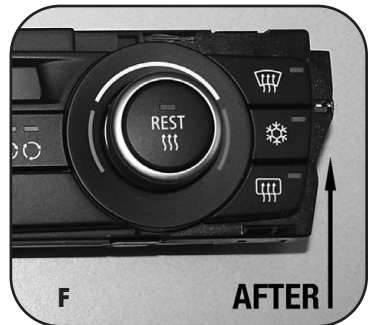

KIT ASSEMBLY

1 Mount the DDIN radio to the supplied DDIN brackets using ISO screws supplied with the aftermarket radio.



2 Locate the factory wiring harness in the dash. Metra recommends using the proper mating adapters from Metra and Axxess to intergrade your new radio. Re-connect the negative terminal and test the unit for proper operation.

3 Mount the radio into the dash. (Figure A)



4 Place the climate controls into the opening below the new radio and push it back as far as it will go, without damaging the dash. (Figure B)

5 Push the included snaps onto the legs on the top of the DDIN trim plate.



6 Clip the two included plastic snaps onto the top legs of the DDIN trim plate. Snap the DDIN trim plate over the radio and use the supplied 1/2" screws to screw into the dash at the bottom. (Figure C)



NOTES

