

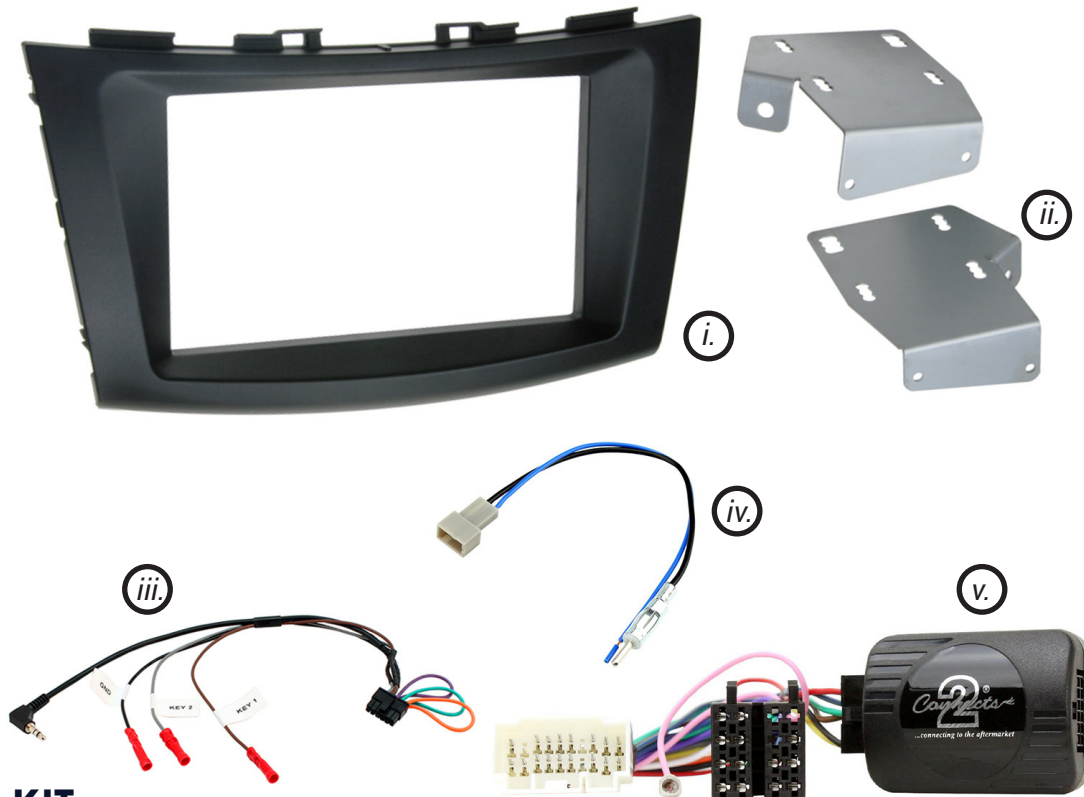

CTKSZ09

## Complete Installation Kit for Suzuki Vehicles



### IN THE KIT

- |      |                         |     |   |
|------|-------------------------|-----|---|
| i.   | Double DIN Fascia Panel | iv. | Vehicle-Specific to DIN Antenna Adapter |
| ii.  | Brackets                | v.  | SWC Interface/Harness                   |
| iii. | Universal Patch Lead    |     |   |

### APPLICATION

Note: Application data is subject to change at any time

Suzuki Swift (FZ/NZ)

2011 - 2017

Designed and  
Engineered  
in the UK. 

### FEATURES

- Allows for the installation of a double DIN aftermarket stereo
- Includes mounting brackets and fitting accessories
- Retains factory steering wheel control & phone button functionality
- Provides output for speed pulse
- Includes additional accessories including antenna adapter and patchlead
- Fascia finished in black to match the dashboard

#### DISCLAIMER

The information provided in this document is subject to change without notice due to manufacturer changes and/or improvements to the product/s. This instruction manual is based on documented data and research. The manufacturer of this product cannot be held responsible for any changes made to the vehicle by the manufacturer or damages that may occur through the installation of this product in accordance with the steps outlined herein.

# PRODUCT INFORMATION

The **CTKSZ09** is a complete installation kit that provides a solution for Suzuki Swift vehicles when installing an aftermarket head unit. This kit contains an analogue steering wheel interface and harness which helps retain the steering wheel controls and factory phone button functionality of the vehicle (if vehicle is equipped). The lead features plug-and-play connectors for an easier installation process. Also provided is a vehicle specific antenna adapter, and a universal patch lead, to ensure compatibility with almost any head unit on the market.

## WIRING KEY

### IN ISO CONNECTOR

Purple	Right Rear Speaker +	Yellow	Permanent 12V
Purple/Black	Right Rear Speaker -	Black	Ground
Green	Left Rear Speaker +	Red	Ignition 12V
Green/Black	Left Rear Speaker -	Orange	Illumination
Grey	Right Front Speaker +		
Grey/Black	Right Front Speaker -		
White	Left Front Speaker +		
White/Black	Left Front Speaker -		

### ADDITIONAL CONNECTIONS

Pink	Speed Pulse
------	-------------

## STEERING WHEEL CONTROL FUNCTIONALITY

*The following diagram, though based on careful research, is an example only. Individual steering wheel control configurations may differ.*

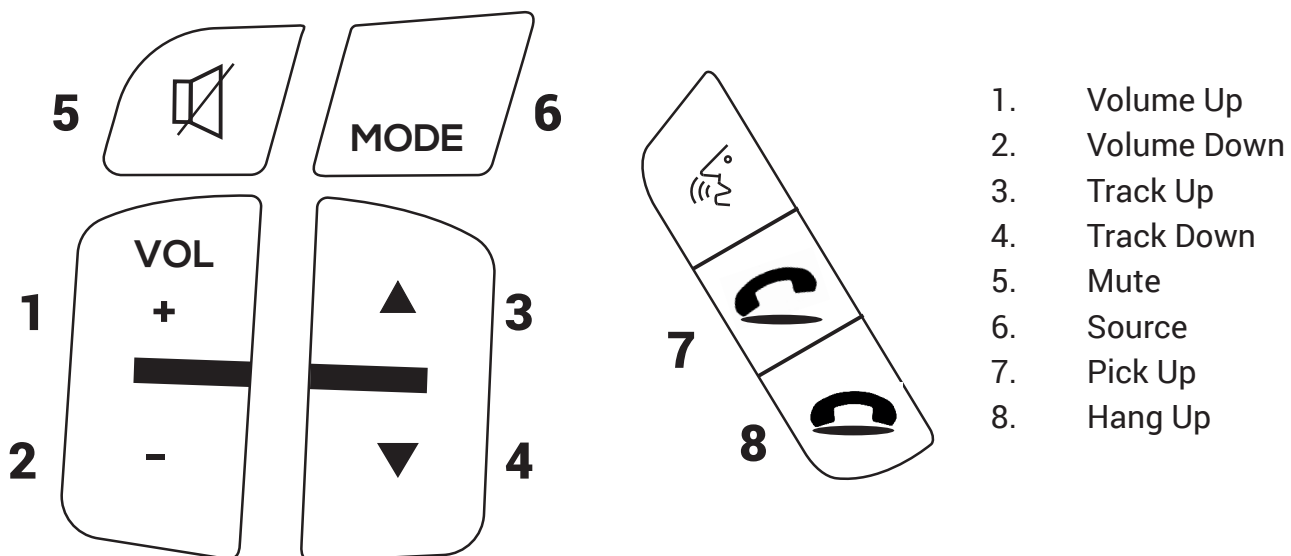

# FASCIA DIAGRAM

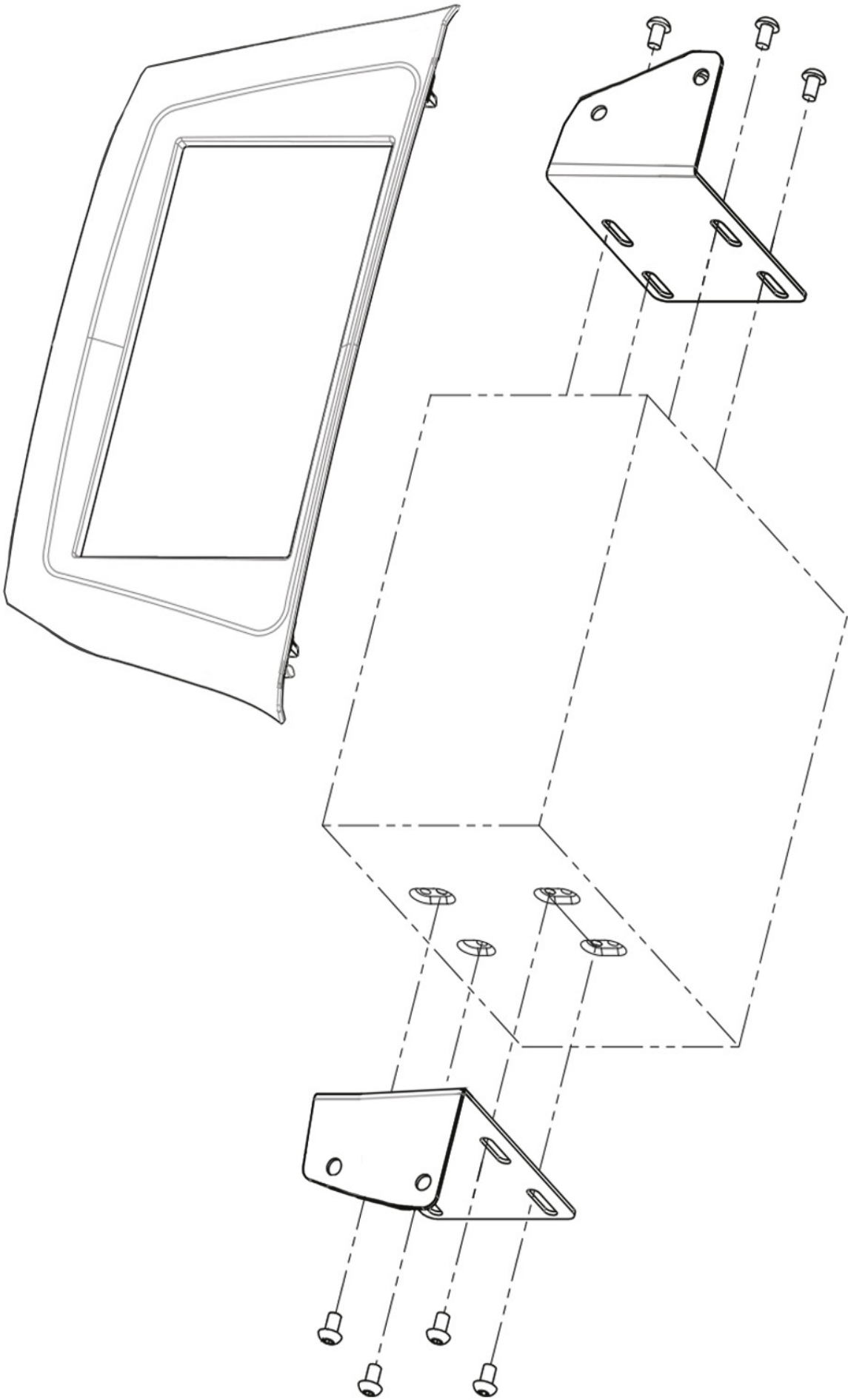

# WIRING DIAGRAM

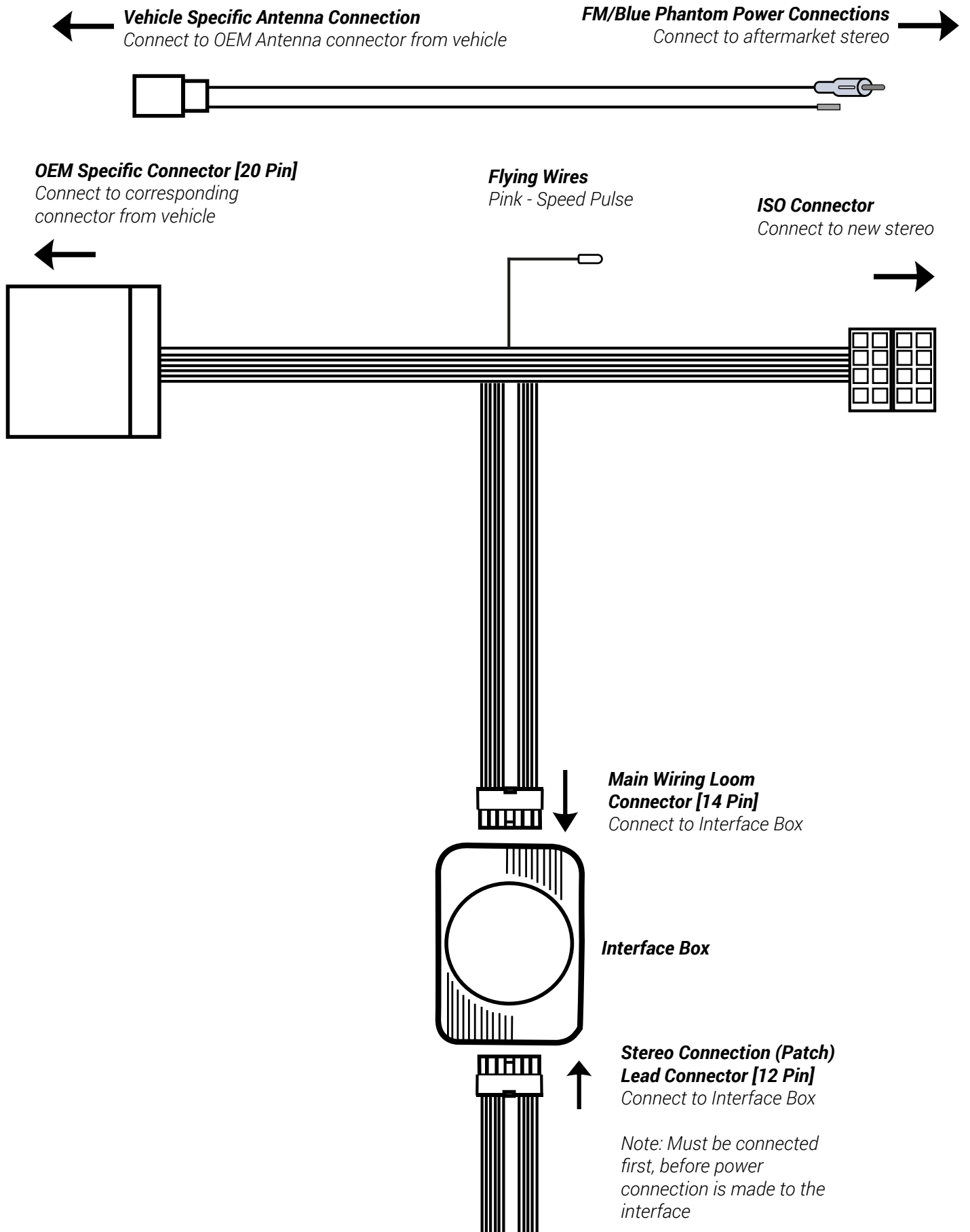

# PRIOR TO INSTALLATION

Read the manual prior to installation. Technical knowledge is necessary for installation. The place of installation must be free of moisture and away from heat sources. Please ensure that the correct tools are used during the installation to avoid damage to the vehicle or product. **Connects2 can not be held responsible for the installation of this product.**

## INSTALLATION GUIDE - FASCIA

### DASH DISASSEMBLY



Begin by using a panel removal tool to disengage 3x retaining clips either side of the air vents. Once free, pull forward and upwards out of the dashboard and disconnect the hazard switch in the process.



Undo 2x screw located at the top rear of the head unit.



Once free, pull the head unit forward and disconnect all of the wiring.

Need help? Visit [support.connects2.com/tickets/technical](https://support.connects2.com/tickets/technical)



# INSTALLATION GUIDE

## BRACKET ASSEMBLY

4.



Attach the brackets to the rear of the head unit and proceed to fit the head unit between. Line up to the front of the fascia and adjust where appropriate.

## DASH ASSEMBLY

5.



Once all of the wiring has been completed, take the fascia/head unit combination and install it into the dashboard, reassembling the vehicle in reverse order to complete the installation.

# INSTALLATION GUIDE - WIRING

See wiring diagram on Pg.4 for more information

Before installing the interface, the factory stereo must be removed and disconnected. To do this, please consult the vehicle owner's manual/handbook or contact a fitting professional.

For universal patch leads, prepare the wiring loops in accordance with the instruction manual supplied before installation.

1. Connect the 12 Pin connector from the stereo connection (patch) lead to the interface box.
2. Connect the opposite end of the stereo connection (patch) lead to the steering wheel control input on the back of the aftermarket stereo.

*NOTE: This may be a 3.5mm jack connector or a wired input depending on the brand of aftermarket stereo being fitted. Please consult the aftermarket stereo installation manual for further information on where to make the connection.*

**! IMPORTANT: THIS STEP MUST BE COMPLETED BEFORE CONNECTING POWER TO THE INTERFACE. FAILURE TO DO SO MAY RESULT IN A LACK OF FUNCTIONALITY AND THE NEED TO REINSTALL THE PRODUCT.**

3. Connect the 14 Pin connector from supplied wiring loom to the interface box.
4. Connect the power/speaker ISO connector to the power/speaker ISO connector at the rear of aftermarket stereo.

*Note: For aftermarket stereos which do not have an ISO connector, please see 'Wiring Key' on Pg.2 for information on which wires to connect.*

5. Connect any additional flying wires from the harness to the head unit as required.

*Note: Additional 'flying' wires can be connected to the vehicle to support various features i.e. parking brake trigger, reverse gear and speed pulse. Details of these can be found under 'Additional Connections'.*

6. Attach the antenna adapter in between the vehicles pre-existing connector as well as the rear of the aftermarket head unit.

**NOTE: If vehicles which feature an amplified aerial, the blue wire will be needed for purposes of phantom power.**

7. Connect the vehicle specific connector to the vehicles main power connector.
8. Test stereo and steering wheel control functionality for correct operation before reassembling the vehicle dashboard. If steering wheel control functions are unresponsive, please uninstall the interface and wiring and reinstall carefully in accordance with the above steps.

***For further help, please contact and fill out a support ticket with the full details of your issue at:  
[support.connects2.com/tickets/technical](https://support.connects2.com/tickets/technical)***

# NOTES

---